

# CARSON<sup>®</sup>

## LuméSeries™

AS-90

### 2.5x Acrylic Lens LED Magnifier with 7x Spot Lens

Congratulations on selecting your new magnifier! In order to achieve optimum performance, please follow instructions for proper use and care.



#### PRODUCT SPECIFICATION

Magnification:	2.5x/7x Spot Lens	Dimensions:	4.6" x 1.0" x 9.7"
Lens Diameter:	3.5"	Illumination:	3 COB LED
Weight:	0.29 lbs	Batteries:	2 AAA (not included)

#### INSTALLING BATTERIES

1. Push battery door and slide to remove.
2. Insert two AAA batteries in the correct polarity indicated.
3. Replace battery door when finished.

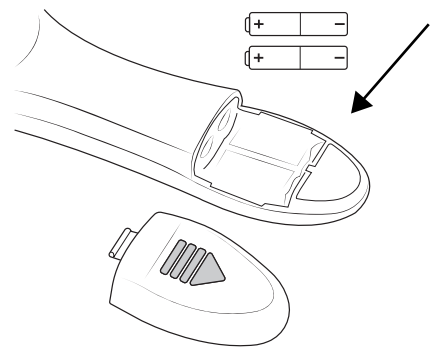

#### WARNING

Mixing old and new, different brands or types within brands may cause batteries to leak, overheat or explode. Keep away from fire or excessive heat. Inspect batteries for corrosion or leakage. Insert in correct polarity.

#### USING LED LIGHT

Slide switch to turn LED ON/OFF.

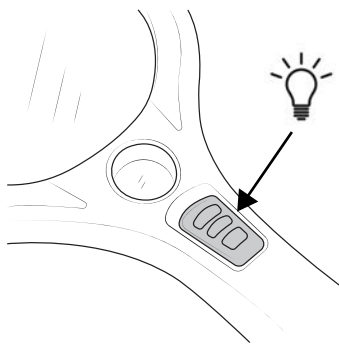

#### USING THE MAGNIFIER

Place magnifier over the subject you are viewing.

##### For Best Results:

- Depending on your vision, you may need to move the magnifier closer or further away until focused.

#### USING THE SPOT LENS

To see superfine details, use the spot lens.

##### For Best Results:

- The magnifier should be close to the subject when using the spot lens.

#### CARE

Clean using microfiber lens cloth. Do not use any abrasives, chemical cleaners, or solvents.

**Customer Service:** If you experience any difficulties, please contact us and we will be happy to help you.



✉ info@carson.com



✉ uksupport@carson.com



✉ eusupport@carson.com

**www.carson.com**

Carson Optical 2070 5th Avenue,  
Ronkonkoma, NY 11779  
Tel: 631-963-5000

For warranty information, visit [www.carson.com/warranty](http://www.carson.com/warranty)