

CARSON®

MeasureLoupe™

11.5x LED / UV Lighted Loupe



CP-45

Congratulations on selecting your new MeasureLoupe 11.5x LED / UV Lighted Loupe! In order to achieve optimum performance, please follow instructions for proper use and care.

PRODUCT SPECIFICATIONS

| | | | |
|----------------|--------------------------------|--------------|-----------------------------------|
| Magnification: | 11.5x | Batteries: | 3 AAA (not included) |
| Weight: | 0.22 lbs (excluding batteries) | Accessories: | Reticle & Protective Storage Case |
| Dimensions: | 5.5" x 2.3" x 2.0" | | |

INSTALLING BATTERIES

1. Twist cap at end of handle counterclockwise to take off.
2. Take out battery housing from handle. Place 3 AAA batteries into housing with the correct polarity markings. Insert loaded battery housing (positive end first) and replace cap.

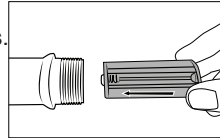
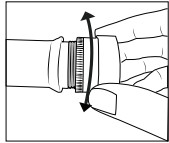

BATTERY WARNING

Use only alkaline batteries. Mixing old and new, different brands or types within brands may cause batteries to leak, overheat or explode. Keep away from fire or excessive heat. Inspect batteries for corrosion or leakage. Insert in direction indicated. Rechargeable batteries not recommended.

TURNING ON LED / UV

Slide switch:

- To the left to turn on LED
- To the right to turn on UV
- To the middle to turn OFF

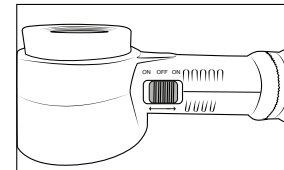

CAUTION - FIRE HAZARD:
Keep magnifier away from direct sunlight to prevent accidental fire.

USING SUPPORT ADAPTER RING

Slide support adapter ring on the end of the handle with point side down for hands-free viewing.

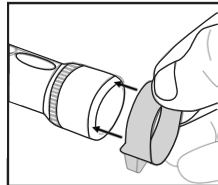

USING LOUPE

Turn on LED or UV Light. Then place magnifier directly upon viewing surface. For best results, place eye close to loupe.

WARNINGS

- Do not look directly into LED or UV Light.
- Do not look at the sun or other bright lights with lens as eye damage may occur.

ATTACHING AND REMOVING RETICLE

1. To remove reticle, turn counterclockwise to unlock. Then lift up reticle to remove.

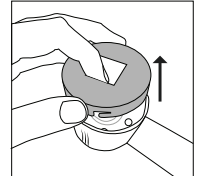
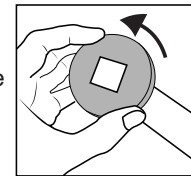

2. To reattach reticle, line up slits with notches inside base of loupe. Press into place and turn clockwise to lock.

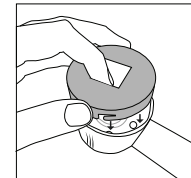

CARE

- Clean using microfiber lens cloth. Do not use any abrasives, chemical cleaners, or solvents.
- To prevent scratching lens, return to protective case when not in use.

Customer Service: If you experience any difficulties, please contact us and we will be happy to help you. **For warranty information,** visit www.carson.com/warranty



✉ info@carson.com

✉ uksupport@carson.com

✉ eusupport@carson.com