

# CARSON<sup>®</sup>

## LightFlexPro<sup>™</sup>

LF-10

### LED Task Lamp

Congratulations on selecting your new LightFlex! In order to achieve optimum performance, please follow instructions for proper use and care.

### PRODUCT SPECIFICATIONS

Weight:	1.78 lbs	Batteries:	4 AA (not included)
Dimensions:	3.2" x 2.7" x 24.0"	Accessories:	AC/DC Adapter



### INSTALLING BATTERIES

1. Remove battery door. Then remove battery case from compartment (Fig. 1).
2. Place 4 AA batteries according to correct polarity indicated inside case.
3. Insert loaded battery case into battery compartment with metal contacts facing upwards. Replace battery door when finished (Fig. 2).



Fig. 1



Fig. 2

### WARNING

Use only alkaline batteries. Mixing old and new, different brands or types within brands may cause batteries to leak, overheat or explode. Keep away from fire or excessive heat. Inspect batteries for corrosion or leakage. Insert in direction indicated. Rechargeable batteries not recommended.

### INSTRUCTIONS FOR USE

1. Place metal plate on stable, flat surface. Attach light to metal plate in desired position using built-in magnet located inside light.
2. To use with table clamp, place open C-clamp onto a table or hard surface and tighten securely by handle (Fig. 3). Then place light on top of clamp using built-in magnet located in light's base (Fig. 4).
3. To use with battery power, remove plug from power jack. The unit will automatically switch to battery power.
4. Turn on light switch located on the front of light.

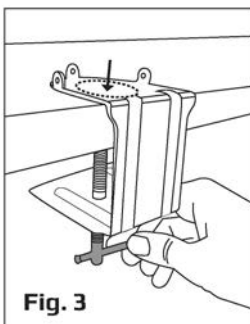
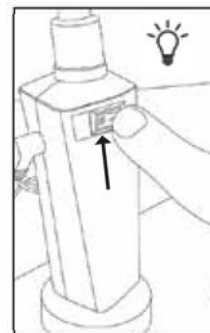

Fig. 3



Fig. 4



**Customer Service:** If you experience any difficulties, please contact us and we will be happy to help you.



✉ [info@carson.com](mailto:info@carson.com)



✉ [uksupport@carson.com](mailto:uksupport@carson.com)



✉ [eusupport@carson.com](mailto:eusupport@carson.com)

**[www.carson.com](http://www.carson.com)**

Carson Optical 2070 5th Avenue,  
Ronkonkoma, NY 11779  
631-963-5000

For warranty information, visit [www.carson.com/warranty](http://www.carson.com/warranty)