

Litewave Pro™

650 Yard Rangefinder

Congratulations on selecting your new Carson Rangefinder! In order to achieve optimum performance, please follow instructions for proper use and care.

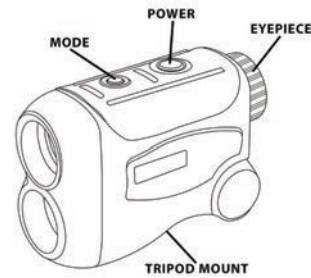

PRODUCT SPECIFICATION

Range:	4~650 yds. (3.5~600m)	Exit Pupil:	4mm
Accuracy:	+/- 0.8 yds. (0.75m)	Eye Relief:	12mm
Magnification:	6x	Display Type:	LCD
Objective Diameter:	24mm	Battery:	CR2 3-volt lithium (included)
Optical Coatings:	Fully multi-coated	Bonus Feature:	Built-in tripod mount
Angle of view:	6.5°	Accessories:	Includes pouch and carry strap
Field of view:	341 ft. at 1000 yards / 114M at 1000M		

LIGHTWAVE™ PRO emits a laser beam that is invisible and safe for the eyes. The Lightwave Pro calculates distances by measuring the time it takes for the laser to travel from the Rangefinder to the target and then back again. The effective operating range is from a minimum of 4 yards to a maximum of 650 yards (3.5 meters to 600 meters). Please note that the maximum operating range may vary due to the reflective properties of the target, the size of the target and the environmental conditions at the time of use. Highly reflective, shiny surfaces allow for longer ranges than dull, less reflective surfaces. Large subjects are easier to measure than small ones. Bright light conditions adversely affect maximum range. The angle to the target may also affect the range. A target at a steep angle will limit the operating range.

FOCUSING

Turn the eyepiece clockwise or counterclockwise until the target is in focus.

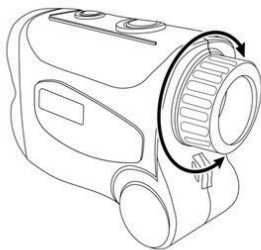

WARNING

Viewing the sun can cause permanent eye damage. Do not view the sun with this Rangefinder or even with the naked eye.

UNITS OF MEASURE

Measure distances in either Yards, Feet or Meters. To change the unit of measure:

1. Power on the unit.
2. Press and hold both the MODE and POWER buttons simultaneously. You will see the recticle display toggle between "Y" (yards), "F" (feet), and "M" (meters).

USAGE MODES

The rangefinder operates in 4 different modes:

- Distance: Measures distance
- Closest (CL) Mode: Measures the slope distance, angle and closest target distance...*Page 2*
- Farther (FA) Mode: Measures the slope distance, angle and farthest target distance...*Page 2*
- Golf Pinseeker and Slope Compensation Mode: Measures slope distance, inclination angle and shot distance...*Page 2*

USING DISTANCE MODE

1. Turn on Unit and press MODE button to access Distance Mode.
2. Align your target in the center of the crosshairs.
3. Press and hold the POWER button to start continuous measuring.
4. Release POWER button to view results of distance on LCD display.

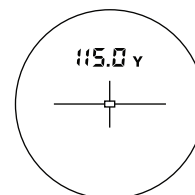

USING CLOSEST (CL) MODE

1. Turn on Unit and press MODE button twice to access CL (closest) Mode.
2. Align your target in the center of the crosshairs.
3. Press and hold the POWER button to start continuous measuring.
4. Release POWER button to view results of distance on LCD display.

LCD will display the readings of straight line (actual distance), inclination angle, and CL distance (minimum value of all values during continuous measuring).

This mode is suitable for golf.

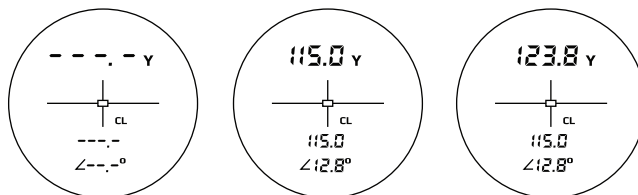

USING FARTHEST (FA) MODE

1. Turn on Unit and press MODE button three times to access FA (farthest) Mode.
2. Align your target in the center of the crosshairs.
3. Press and hold the POWER button to start continuous measuring.
4. Release POWER button to view results of distance on LCD display.

LCD will display the readings of straight line (actual distance), inclination angle, and FA distance (maximum value of all values during continuous measuring).

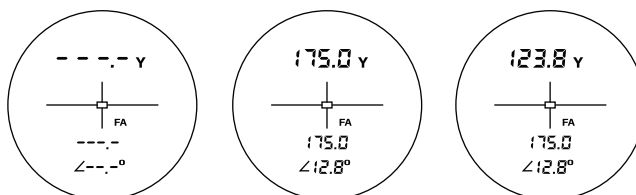

USING GOLF PINSEEKER AND SLOPE COMPENSATION MODE

1. Turn on Unit and press MODE button four times to access GOLF Mode.
2. Align your target in the center of the crosshairs.
3. Press and hold the POWER button to start continuous measuring.
4. Release POWER button to view results of distance on LCD display.

LCD will display the slope distance, inclination angle and shot distance.

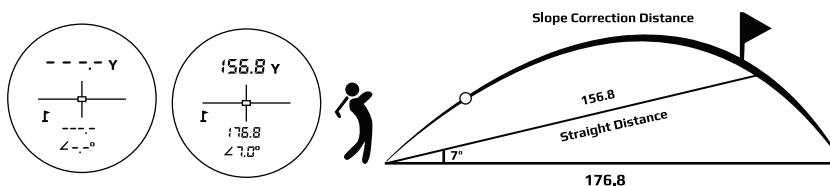

REPLACING BATTERIES

The rangefinder includes a CR2 3-Volt Lithium battery. **Please note: Remove and discard the included tab which was placed in the battery compartment to avoid battery drain during shipping.**

Unscrew battery door. Remove exhausted battery and insert new CR2 3-Volt battery in correct polarity. Replace battery door.

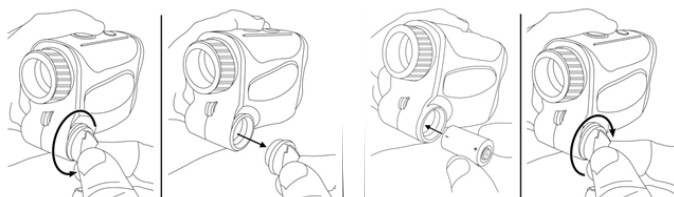

BATTERY WARNING

Keep lithium battery away from fire or excessive heat. Inspect battery for corrosion or leakage. Insert in direction indicated. Battery is not rechargeable.

CLEANING & CARE

Cleaning must be done carefully to avoid scratching the lenses and damaging your Rangefinder Pro. Safe cleaning can be accomplished by the following procedure:

1. Blow away any dust or debris on the lens (or use a soft lens brush.)
2. To remove dirt, grease or fingerprints, clean with a microfiber cloth, rubbing in a circular motion. Use of a coarse, dry cloth may scratch the lens surface and eventually cause permanent damage.
3. For a more thorough cleaning, photographic type lens cleaning fluid may be used. Always apply the fluid to the cleaning cloth, never directly to the lens. Do not use any abrasives, chemical cleaners, or solvents.
4. Never attempt to clean your Rangefinder Pro internally or try to take it apart. This may cause the internal optical components to become misaligned.
5. Place Rangefinder Pro in protective case (included) when not in use.
6. Do not leave in the sun or near a hot surface for extended periods of time.
7. Store in a cool, dry place when not in use.
8. Remove battery during extended periods of disuse.

TRIPOD MOUNT

The Rangefinder Pro features a tripod mount (1/4-20 thread) located on the bottom of the unit to easily attach the item to any standard tripod for more stable use.

FCC NOTE

This device has been tested and complies with the limits for a Class B digital device, Part 15 of the FCC Rules to the EU EMC directive. Two conditions must be met for operation to take place:

(1) This device may not cause harmful interference, and (2) this device must accept any interference received, including interference that may cause undesired operation. These conditions are designed to provide reasonable protection against harmful interference in a residential setting. This equipment generates, uses and can radiate radio frequency energy and, if not installed and used in accordance with the instructions, may cause harmful interference to radio communications.

There is no guarantee that interference will not occur in a particular installation. If this device does cause harmful interference to radio or television reception, the user should correct the interference by one or more of the following measures:

- Reorient or relocate the receiving antenna.
- Increase the separation between the equipment and receiver.
- Consult the dealer or an experienced radio/TV technician for help.

FDA SAFETY

Class 1 laser product in accordance with IEC 60825-1:2007. Complies with 21 CFR 1040.10 and 1040.11 for laser products except for deviations pursuant to Laser Notice No. 50, dated June 24, 2007.

Caution: There are no user controls, adjustments or procedures. Performance of procedures other than those specified herein may result in access to invisible laser light.

Customer Service:

If you experience any difficulties, please contact us and we will be happy to help you.

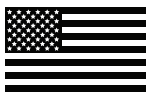

✉ info@carson.com



✉ uksupport@carson.com



✉ eusupport@carson.com

For warranty information, visit www.carson.com/warranty

www.carson.com

Carson Optical 2070 5th Avenue, Ronkonkoma, NY 11779 | Tel: 631-963-5000